

# Installation Guide

Installation Kit: 911-8110-10



## Kubota

M7-131

M7-132

M7-134

M7-151

M7-152

M7-154

M7-171

M7-172

M7-174

## Required Items:

1. Machine must be steer ready
2. Autosteer valve must be calibrated by Kubota dealer before use
3. Kubota Power Switch PN: 3J032-74860 is required for autosteer to function and must be purchased from a Kubota dealer

# Introduction

---

The procedures outlined in this guide provide the basic installation procedure for the eDriveM1 on the machines specified on the front cover of this guide. If you do not see your machine listed, contact customer support for further instruction. The kit components and corresponding install instructions are designated for each applicable machine make and model and may not be used on undesignated machine models.

## **Review Installation Kit Contents**

Kit contents are outlined in the following pages of this installation guide. Read all applicable installation instructions for your machine's model and ensure that all required kit components are present before beginning the installation.

## **Read and Follow All Safety Messages**

- Refer to the safety manual for the machine that the eDriveM1 is being installed on for operating age and precautions.
- Prior to installing and operating the eDriveM1, read and understand all safety precautions as outlined in this guide.
- Store this guide and all related safety information with related machine manuals for future reference.

# Introduction

---

## **Safety Information and Warnings\***

- eDriveM1 is NOT designed to replace the machine's operator and is designed as a driving aid for use in precision agriculture applications.
- eDriveM1 is NOT intended for use on roadways and should remain disengaged at all times when traveling on roadways.
- eDriveM1 does NOT control the speed of the machine and a human operator is required to manually maintain a safe operating speed.
- eDriveM1 does NOT avoid obstacles. To prevent human, machine and property injury a human operator is required to operate the machine at all times.
- Do NOT allow anyone to operate without instructions.
- At all times the driver is fully responsible for the safe operation of the vehicle.

\* The safety warnings contained in this installation guide are not meant to be an exhaustive list of potential hazards.

- To ensure peak performance, eDriveM1 should only be installed after a thorough machine inspection has been conducted. The contents of this kit and eDriveM1 are not intended to replace preventative and or needed maintenance. To avoid bodily and machine injury, follow the machine preparation checklist below:
  - ⇒ Inspect steering linkage: Machine should drive in a straight line without manual correction
  - ⇒ Turn off machine and power-off all electronic gauges, monitors and external devices when installing or performing maintenance on the eDriveM1
  - ⇒ Park machine on a clean and level surface
  - ⇒ Lower all implements and headers to the ground
  - ⇒ Apply the parking break and chock wheels
  - ⇒ Inspect any drilling and/or cutting sites to ensure no electrical wiring damage will be incurred

# Cabling Diagram

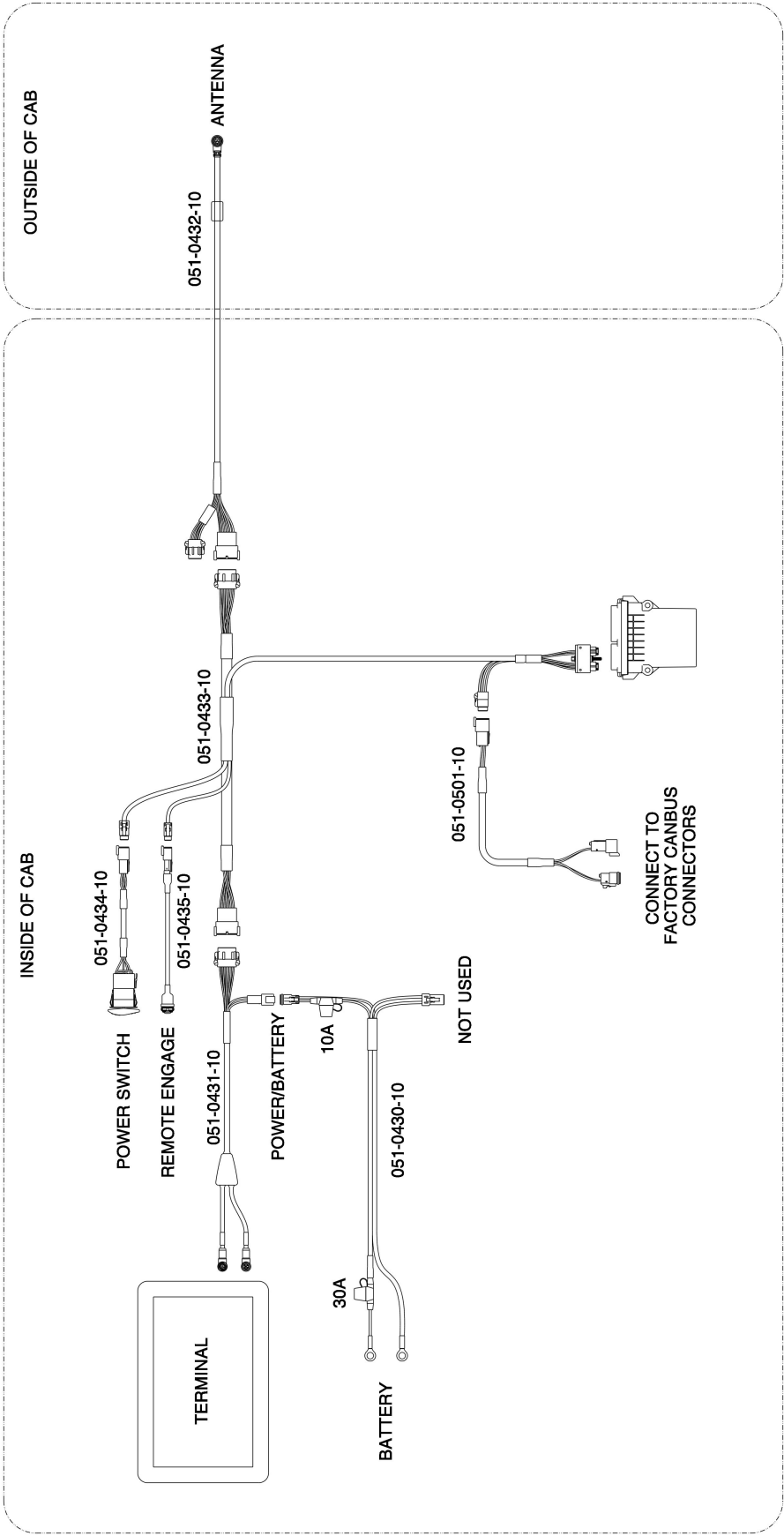
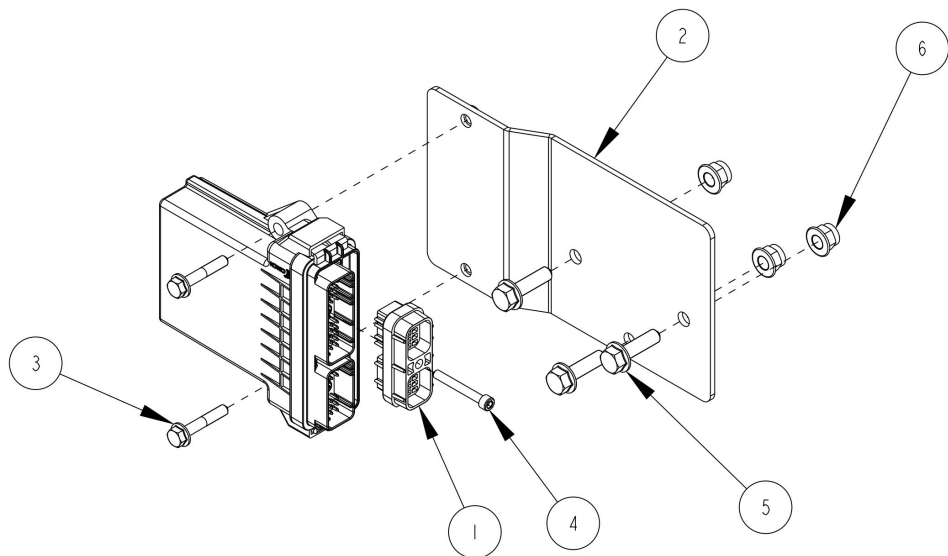

Figure 1



# ECU Installation

Required items for ECU install listed below



ITEM	QTY	PART NUMBER	DESCRIPTION
1	1	400-5170-10	CONNECTOR COVER
2	1	640-0206-10	BRKT, ECU, EDM1, KUBOTA M7
3	2	675-1362-10	SCR,FLANGE,HEX,M6X1X35,ZP
4	1	675-1371-10	SCR, SHCS, NO.10-24 X 1.5, SS
5	3	675-1381-10	SCR,FLANGE,HEX,M8X1.25X30,ZP, FULL THREAD
6	3	676-1106-10	NUT, LOCKING, M8x1.25, NYLON, FLANGED, ZP

Figure 2

Locate and remove the 3 rubber plugs that are on the back wall of the cab behind the operators seat.



Figure 3

# ECU installation

---

Mount the ecu bracket (item 2) to the back of the machine's cab using the m8 hardware (items 5 & 6) Once ecu bracket is mounted secure the ecu to the bracket with the m6 bolts (item 3).

Figure 4 shows additional hardware used to mount the ecu to the bracket.



Figure 4

Figure 5 shows dummy plug installed onto ecu connector.

ECU shown is installed with logo facing forward and connector pointing left. This orientation will need entered into the display for the first calibration step.



Figure 5



# CANBUS Harness Installation

Raise the hood of the machine and locate the autosteer valve that is located on the firewall between the cab and the engine. This is where you will connect the CANBUS harness.



Figure 6

Locate the 3 pin DT CANBUS connection (Figure 7). It will be next to the steering valve and on the left side of the machine. Split apart the CANBUS connection and plug the 051-0501-10 harness into the connection (Figure 8). Make sure the 3 pin terminator plug in Figure 7 is plugged into the 051-0501-10 harness Figure 8. Route the 051-0501-10 harness under the machine and through the back window. Connect harness as shown on figure 1 page 4.



Figure 7



Figure 8



# Installing Autosteer Valve Power Switch

There are two different locations for the autosteer valve power switch. Kubota PN:3J032-74860 will be installed in one of the 2 switch locations shown below. Figures 9 & 10 show switch already installed.



Figure 9



Figure 10

Remove the switch cover and find the white connector that will plug in the back of the power switch. Figures 11 & 12 show what the connector looks like and the corresponding label for the two different variations.



Figure 11

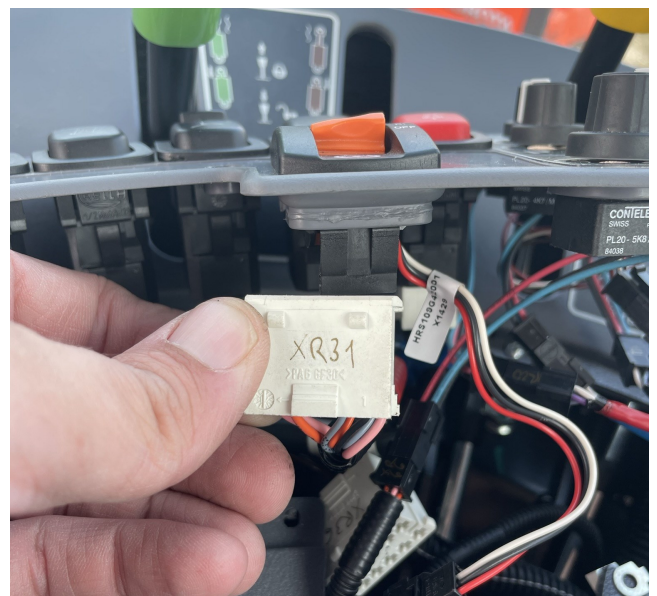

Figure 12

# Installing Autosteer Valve Power Switch

---

If the correct white connector has been used then the red light come on when the valve power switch is switched on.



Figure 13

## **NOTE!!**

**The tractor and the eDriveM1 must first be started up and operational before the autosteer valve power switch is turned on. If you don't follow this startup order an error will pop up on the tractor dash.**

## Initial Setup

---

When creating a new machine in your Maverix terminal, you will need to select “Danfoss CLS” for your machines valve type.

## Troubleshooting & Diagnostics

The machine must have the valve calibrated by a Kubota technician and the autosteer valve power switch must be installed before the autosteer will be functional.