

# Installation Guide

Installation Kit: 911-8111-10



- CLAAS OSI Ready Required
- 1403663.0 unlock required from CLAAS Dealer
- Requires CLAAS Maverix unlock (included with this kit)

## CLAAS

Lexion 620	Lexion 7400	Tucano 320	Trion 520
Lexion 630	Lexion 750	Tucano 340	Trion 530
Lexion 630 Montana	Lexion 750 Montana	Tucano 420	Trion 640
Lexion 650	Lexion 7500	Tucano 430	Trion 650
Lexion 660	Lexion 760	Tucano 430 Montana	Trion 660
Lexion 670	Lexion 760 Montana	Tucano 440	Trion 710
Lexion 670 Montana	Lexion 770	Tucano 450	Trion 720
Lexion 6800	Lexion 780	Tucano 560	Trion 730
Lexion 6900	Lexion 8600	Tucano 570	Trion 740
Lexion 730	Lexion 8700	Tucano 580	Trion 750
Lexion 740	Lexion 8800		

# Introduction

---

The procedures outlined in this guide provide the basic installation procedure for the eDriveM1 on the machines specified on the front cover of this guide. If you do not see your machine listed, contact customer support for further instruction. The kit components and corresponding install instructions are designated for each applicable machine make and model and may not be used on undesignated machine models.

## **Review Installation Kit Contents**

Kit contents are outlined in the following pages of this installation guide. Read all applicable installation instructions for your machine's model and ensure that all required kit components are present before beginning the installation.

## **Read and Follow All Safety Messages**

- Refer to the safety manual for the machine that the eDriveM1 is being installed on for operating age and precautions.
- Prior to installing and operating the eDriveM1, read and understand all safety precautions as outlined in this guide.
- Store this guide and all related safety information with related machine manuals for future reference.

# Introduction

---

## **Safety Information and Warnings\***

- eDriveM1 is NOT designed to replace the machine's operator and is designed as a driving aid for use in precision agriculture applications.
- eDriveM1 is NOT intended for use on roadways and should remain disengaged at all times when traveling on roadways.
- eDriveM1 does NOT control the speed of the machine and a human operator is required to manually maintain a safe operating speed.
- eDriveM1 does NOT avoid obstacles. To prevent human, machine and property injury a human operator is required to operate the machine at all times.
- Do NOT allow anyone to operate without instructions.
- At all times the driver is fully responsible for the safe operation of the vehicle.

\* The safety warnings contained in this installation guide are not meant to be an exhaustive list of potential hazards.

- To ensure peak performance, eDriveM1 should only be installed after a thorough machine inspection has been conducted. The contents of this kit and eDriveM1 are not intended to replace preventative and or needed maintenance. To avoid bodily and machine injury, follow the machine preparation checklist below:
  - ⇒ Inspect steering linkage: Machine should drive in a straight line without manual correction
  - ⇒ Turn off machine and power-off all electronic gauges, monitors and external devices when installing or performing maintenance on the eDriveM1
  - ⇒ Park machine on a clean and level surface
  - ⇒ Lower all implements and headers to the ground
  - ⇒ Apply the parking break and chock wheels
  - ⇒ Inspect any drilling and/or cutting sites to ensure no electrical wiring damage will be incurred

# Cabling Diagram

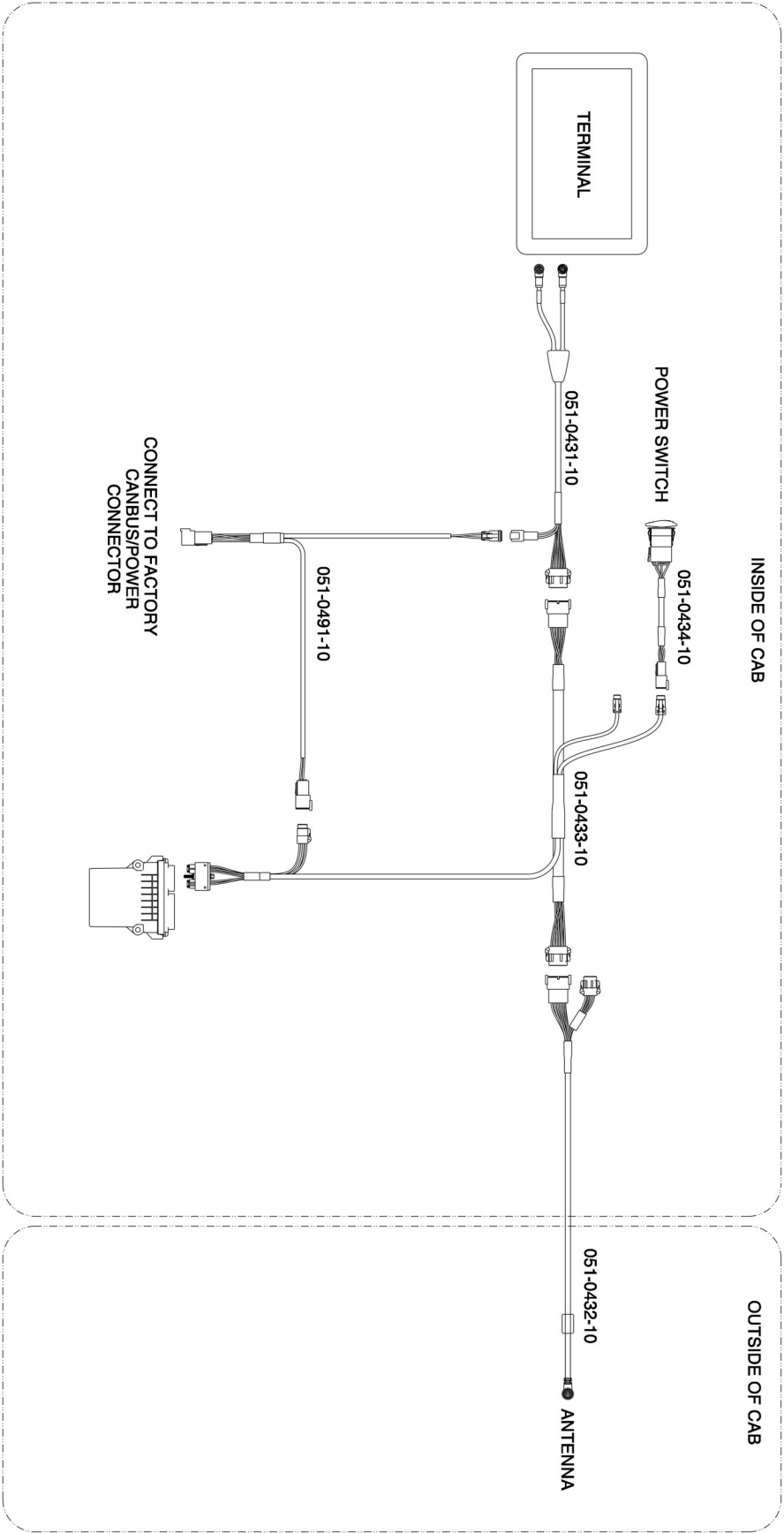
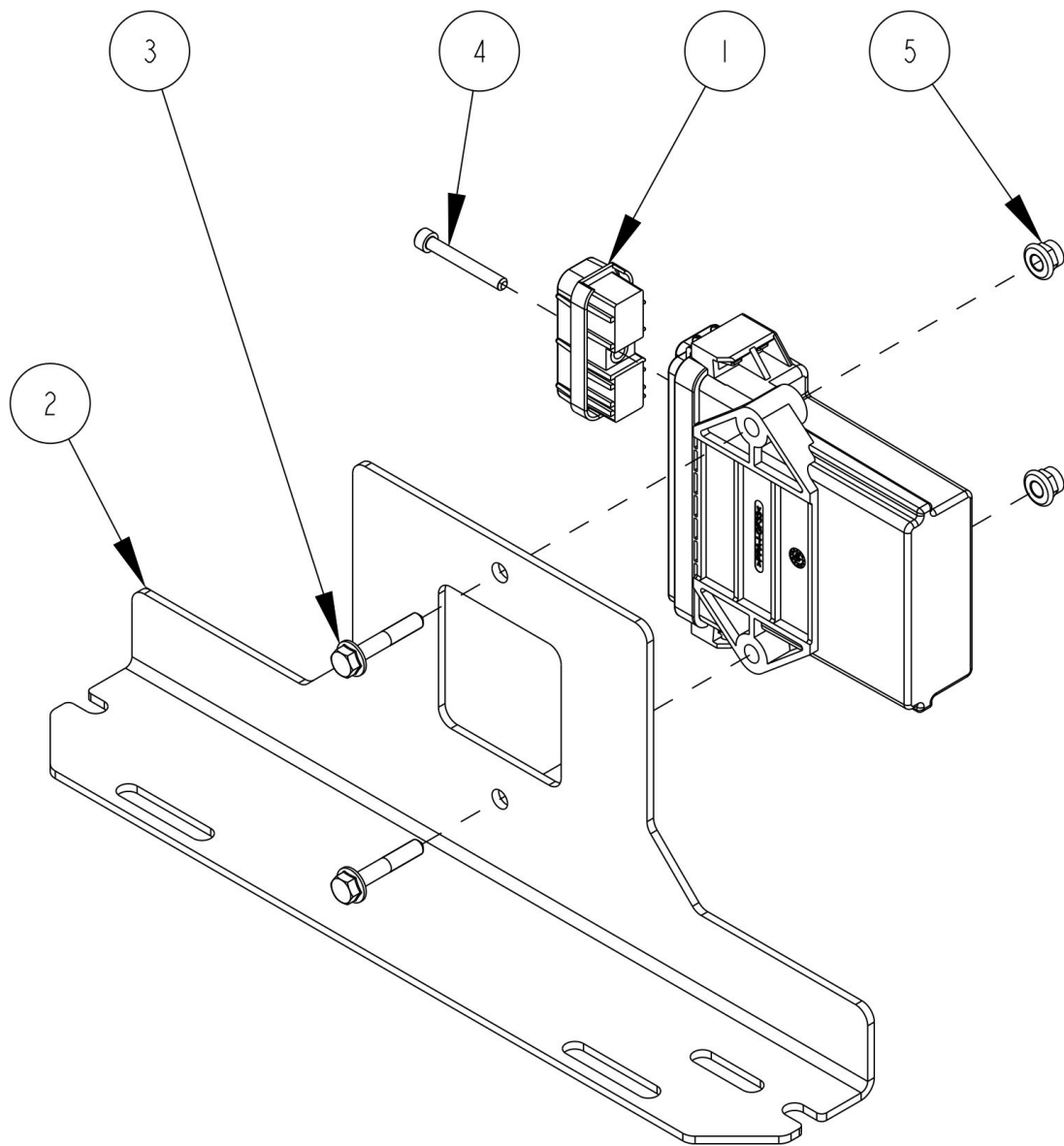

Figure 1

# ECU Installation

Required items for ECU install listed below



ITEM	QTY	PART NUMBER	DESCRIPTION
1	1	400-5170-10	CONNECTOR COVER
2	1	640-0207-10	BRKT, ECU, EDM1, CLAAS LEXION
3	2	675-1362-10	SCR,FLANGE,HEX,M6X1X35,ZP
4	1	675-1371-10	SCR, SHCS, NO.10-24 X 1.5, SS
5	2	676-1089-000	NUT,M6X1.0,NYLOK,FLANGED,ZP

Figure 2

## ECU Installation - Older Model Cabs

---

Remove the plastic cover behind the seat to gain access to the ecu mounting location. Remove and **SAVE** the 2 bolts that secure the factory bracket to the floor.



Figure 4

Secure the steering ecu to the bracket (item 2) using hardware (items 3&5).

Use the 2 bolts from the previous step and secure the ecu bracket (item 2) to the floor of the cab.

ECU shown in Figure 5 is installed with logo facing rear and connector pointing right. This orientation will need entered into the display for the first calibration step.



Figure 5



## ECU Installation - Newer Model Cabs

---

Remove the plastic cover behind the seat to gain access to the ecu mounting location. Remove and **SAVE** the 2 bolts that secure the factory bracket to the floor.



Figure 6

Secure the steering ecu to the bracket (item 2) using hardware (items 3&5).

Use the 2 bolts from the previous step and secure the ecu bracket (item 2) to the floor of the cab.

ECU shown in Figure 7 is installed with logo facing rear and connector pointing right. This orientation will need entered into the display for the first calibration step.

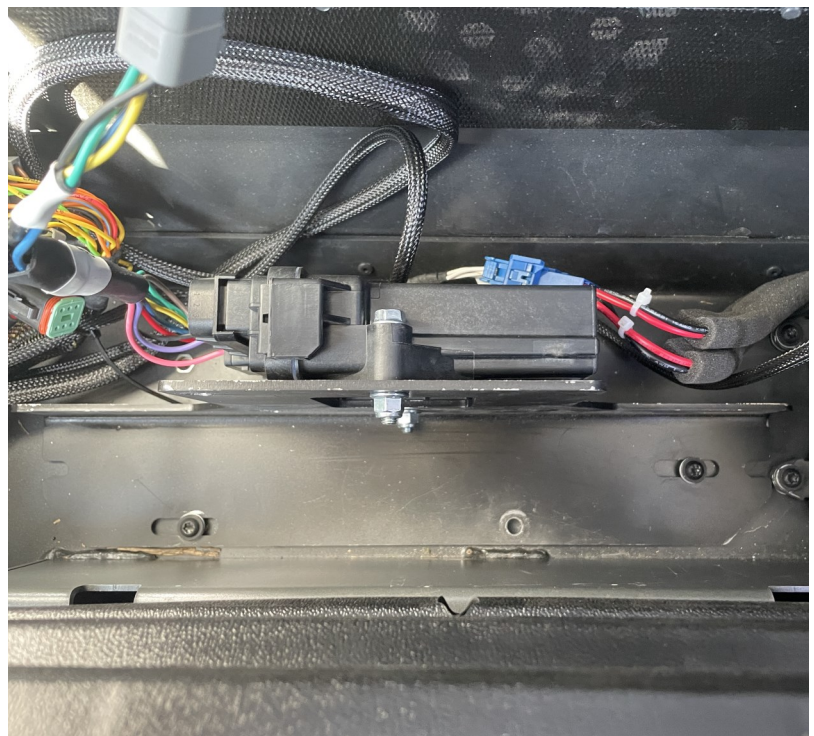

Figure 7

# CANBUS Harness Installation

---

Locate the 6 pin Deutsch DT connector in the rear compartment behind the seat.

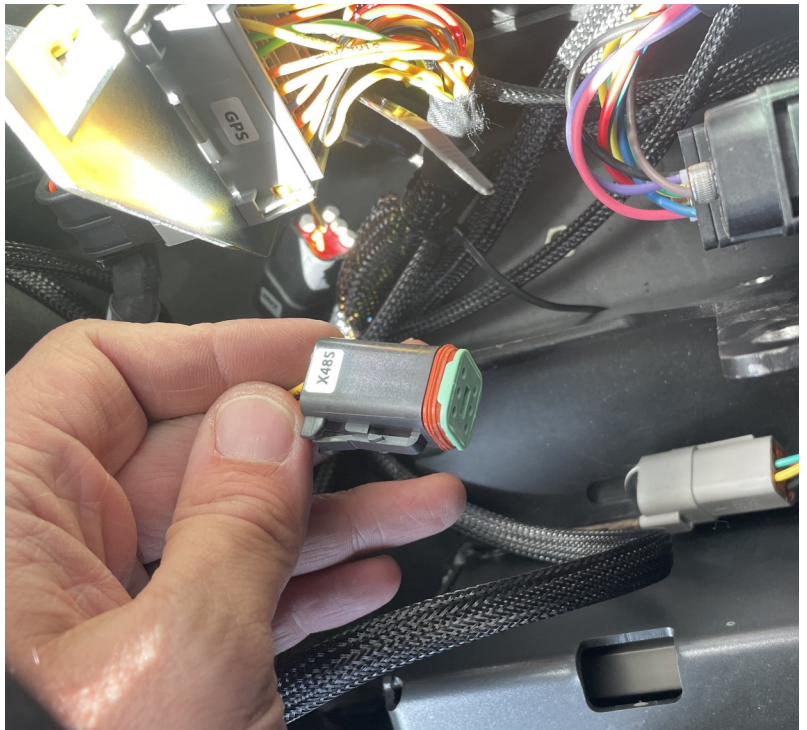

Figure 8

Connect the 051-0491-10 cable to the 6 pin Deutsch connector.

Connect the remaining ends of the 051-0491-10 cable as shown in Figure 1 on page 4.



Figure 9



## Roading switch and Remote engage

Locate the roading switch on the top right side of the cab. Autosteer is not possible while roading switch is enabled.



Figure 10

Autosteer system engagement is only possible using the remote engage button on the CLAAS C-MOTION Multi-function Lever. Using the engage button on the Outback terminal will result in an error message.

Machine separator must be turned on before autosteering will be possible.

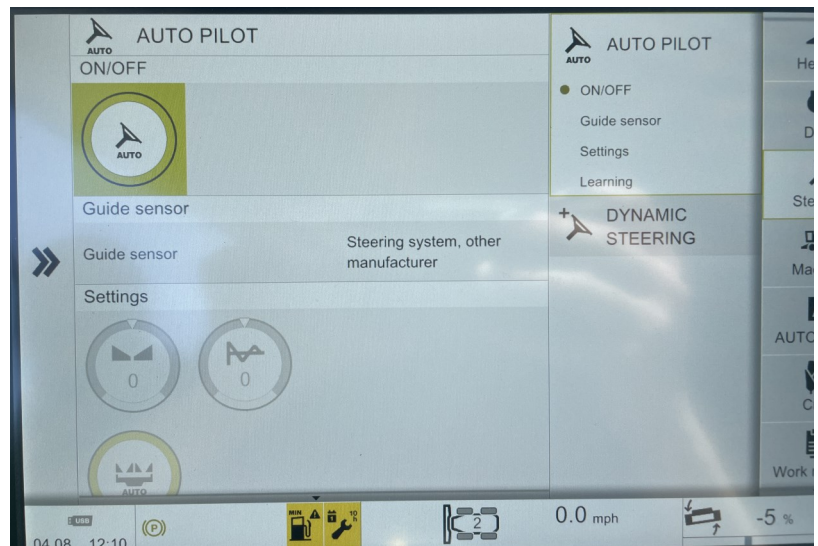

Figure 11

Press on the steering icon from the CEBIS home screen.



Turn the the Autopilot ON and select “steering system, other manufacturer” to enable steering from a third party manufacturer.



## Initial Setup

---

When creating a new machine in your Maverix terminal, you will need to select “CLASS OSI” for your machines valve type.

## Troubleshooting & Diagnostics

Autosteer system must be unlocked by a CLAAS dealer using a manufacturer specific unlock. The autosteering valve must be calibrated by a CLAAS dealer prior to using the autosteering system. Poor autosteering performance can occur if a proper valve calibration hasn't been done.