



Dual Relay Run/Hold Switch Kit

P/N: OBK-360-DRH

Overview

Install this kit to simultaneously start and stop the acre counting in the Outback 360 together with an automatic rate controller, using a single external Master Run/Hold switch. Recommended for use with Mid-Tech, Micro-Trak, and Spraying Systems brand controllers or any device that requires a simple switch closure input to turn it on or off.

Kit Contents

The dual run/hold switch kit includes a double relay and wire harness with two run/hold switch outputs, a single input switch connector, hook up wire for 12-volt power and ground, along with instructions. The floor switch included with the Outback 360 is used as the external run/hold switch for both applications.

Installation

Insert the two wire plug into mating connector of the Outback 360 remote run/hold switch input (A).

Install the floor switch included with the Outback 360 and plug into the mating connector (B).

Connect the red wire to +12 volt power and the black wire to ground.

Locate the run/hold sensor input connector on the automatic rate controller and connect to the second switched output. Look for a wire loop in the connector cap. Cut the wire and crimp on the two butt connectors.

Use the floor switch to control both the Outback 360 and the automatic rate controller

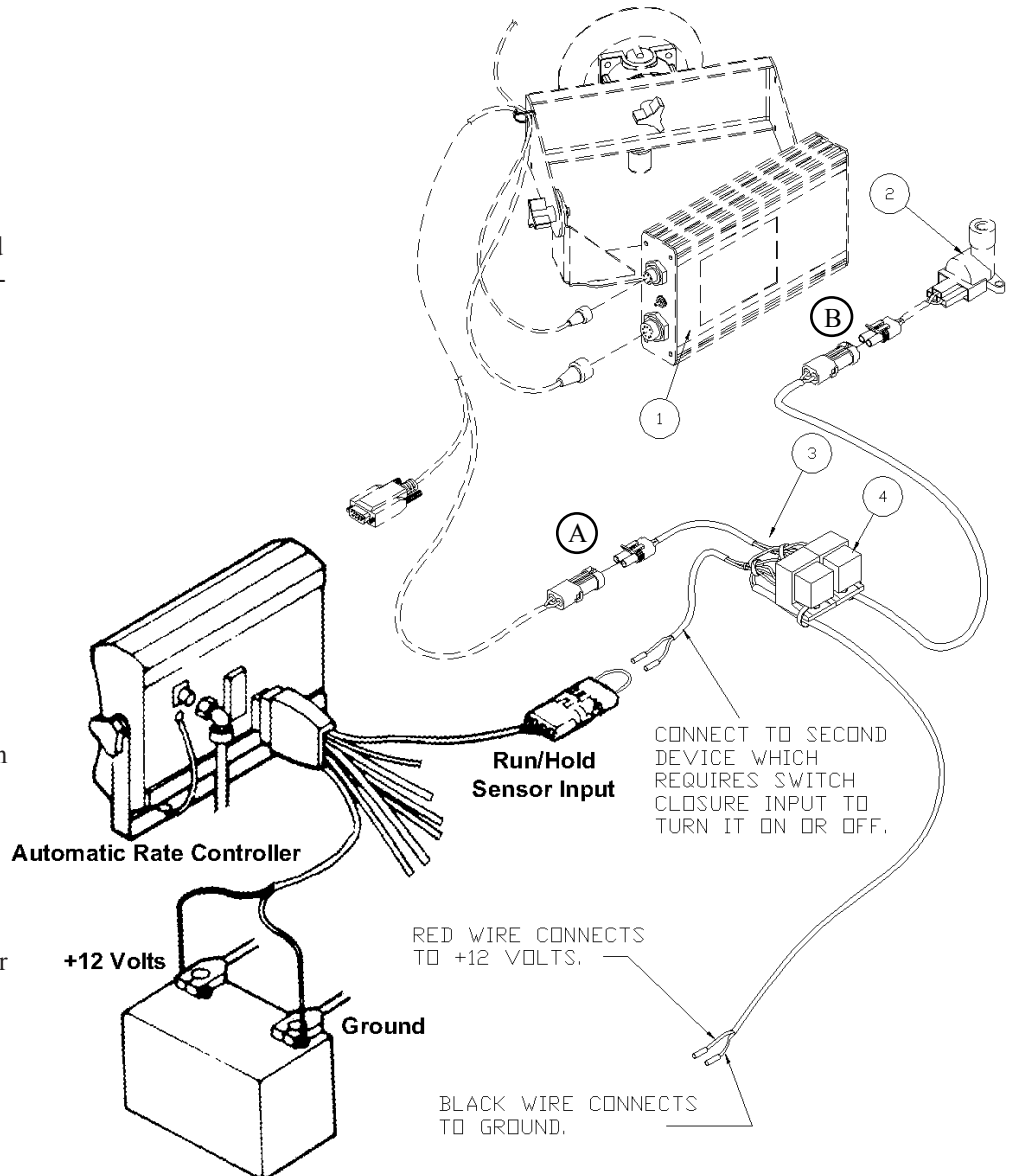

REF.	P/N	DESCRIPTION	QTY.
1	OBK-360	Outback 360 Mapping System	
2	AB446	Run/Hold Switch Assembly OBK-360	
3	AB448	Wire Harness, Dual Relay Run/Hold	1
4	69253-OBK	Relay, 40A-SPST-NO	2