

Installation Guide

Installation Kit: 911-6102-10



<u>Harvest Pro:</u>	<u>Premier:</u>	<u>MacDon:</u>	<u>Westward:</u>
8150	2900	9000	9000
8152	2920	9200	9200
8152c	2930	9220	9220
8152i	2940	9250	9250
	2950	9300	9300
	2952	9350	9350
<u>Prairie Star:</u>	2952c	9352	9352
4900	2952i	9352c	9352c
4920		9352i	9352i
4930			
4940	<u>John Deere:</u>	M100	
4950	W110	M105	
4952			
4952c			
4952i			

Introduction

The procedures outlined in this guide provide the basic installation procedure for the ESi² on the machines specified on the front cover of this guide. If you do not see your machine listed, contact customer support for further instruction. The kit components and corresponding install instructions are designated for each applicable machine make and model and may not be used on undesignated machine models.

Review Installation Kit Contents

Kit contents are outlined in the ESi² installation section on pages 8&9. Read all applicable installation instructions for your machine's model and ensure that all required kit components are present before beginning the installation.

NOTE: Due to manufacturing processes outside of Outback Guidance's control, the installer may have to adapt this kit to your distinct situation.

Read and Follow All Safety Messages

- Refer to the safety manual for the machine that the ESi² is being installed on for operating age and precautions.
- Prior to installing and operating the ESi², read and understand all safety precautions as outlined in this guide
- Store this guide and all related safety information with related machine manuals for future reference.

Safety Information and Warnings*

- ESi² is NOT designed to replace the machine's operator and is designed as a driving aid for use in precision agriculture applications.
- ESi² is NOT intended for use on roadways and should remain disengaged at all times when traveling on roadways.
- ESi² does NOT control the speed of the machine and a human operator is required to manually maintain a safe operating speed.
- ESi² does NOT avoid obstacles. To prevent human, machine and property injury a human operator is required to operate the machine at all times.
- Do NOT allow anyone to operate without instructions.
- At all times the driver is fully responsible for the safe operation of the vehicle.

* The safety warnings contained in this installation guide are not meant to be an exhaustive list of potential hazards.

Introduction

- To ensure peak performance, ESi² should only be installed after a thorough machine inspection has been conducted. The contents of this kit and ESi² are not intended to replace preventative and or needed maintenance. To avoid bodily and machine injury, follow the machine preparation checklist below:
 - ⇒ Inspect steering linkage: Machine should drive in a straight line without manual correction
 - ⇒ Turn off machine and power-off all electronic gauges, monitors and external devices when installing or performing maintenance on the ESi²
 - ⇒ Park machine on a clean and level surface
 - ⇒ Lower all implements and headers to the ground
 - ⇒ Apply the parking break and chock wheels
 - ⇒ Inspect any drilling and/or cutting sites to ensure no electrical wiring damage will be incurred

Machine Preparation

Your machine will have one of two columns pictured.

The column with the plastic cover (right) will require an additional step later in this installation.



Machine Preparation

While supporting the shaft from below the cab (unsupported it will drop down inside of the column) use a punch and hammer to drive out the roll pin from the steering shaft.

Remove

***NOTE** If your machine's steering column has a plastic cover then you may have to turn the wheel to align the roll pin with the slots in the plastic cover.



Once the roll pin is removed you can remove the steering wheel. You can use a punch to keep the steering shaft from sliding down into the steering column.

If your machine has the metal column, then you are ready for the ESi² Installation.



Machine Preparation

Remove the plastic cover from the column and disconnect the ground speed LCD wiring connector. Discard this plastic cover.



Steering column is ready for ESI² Installation.



ESi² Installation

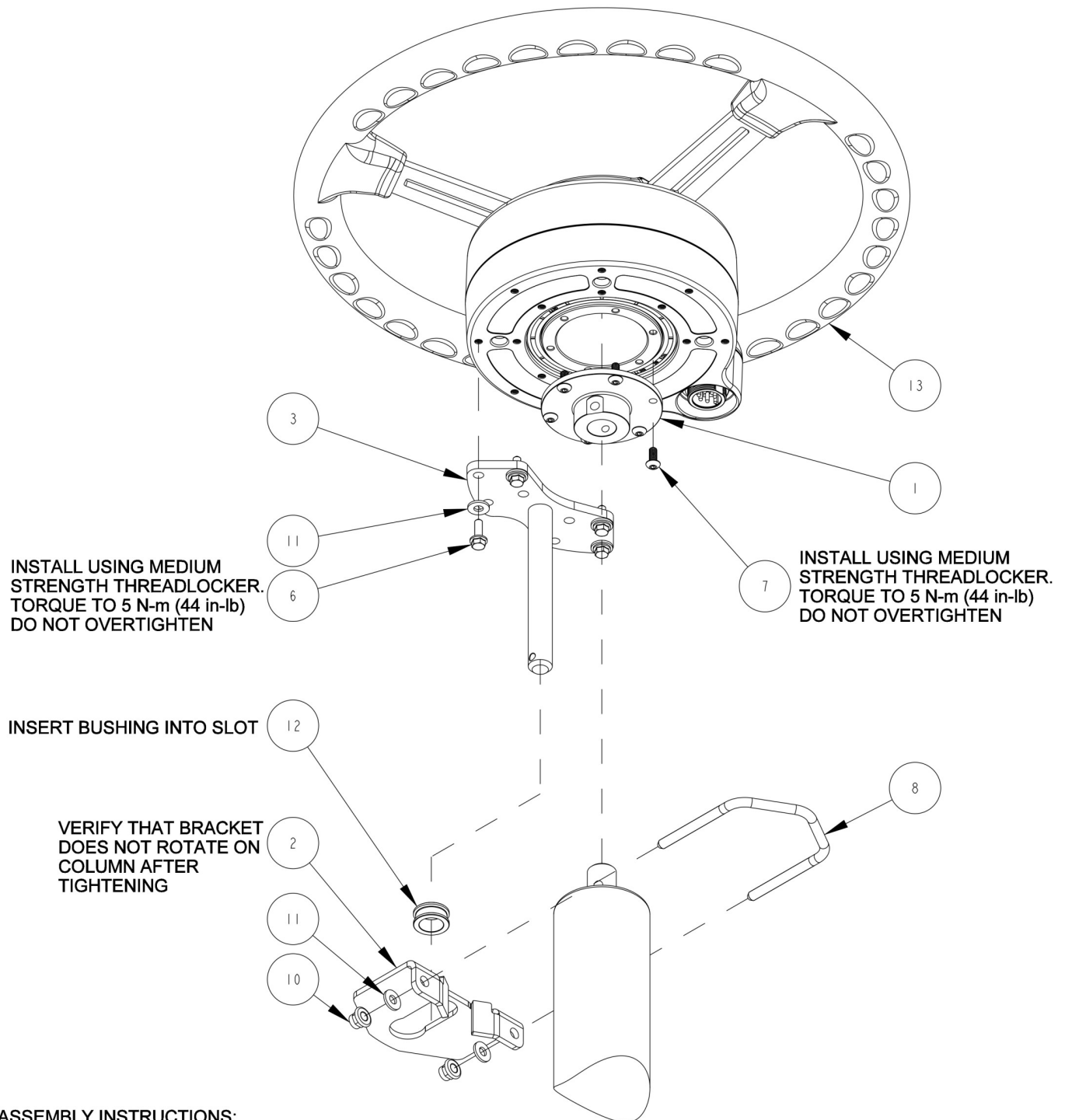

ASSEMBLY INSTRUCTIONS:

1. PRE-ASSEMBLE SPLINE ADAPTER AND T-BAR TO WHEEL MOTOR.
2. ASSEMBLE BRACKET AND CLAMP TO STEERING COLUMN. BRACKET, T-BAR, AND WHEEL MOTOR ORIENTATION MAY VARY TO FIT YOUR APPLICATION.
3. INSERT BUSHING INTO SLOT IN BRACKET.
4. PLACE ASSEMBLY ON STEERING SHAFT AND INSTALL RETAINING BOLT
5. INSTALL RETAINING PIN IN T-BAR.

ESi² Installation

INSTALL USING MEDIUM STRENGTH THREADLOCKER. TORQUE TO 9.5 N-m (7 ft-lb) DO NOT OVERTIGHTEN

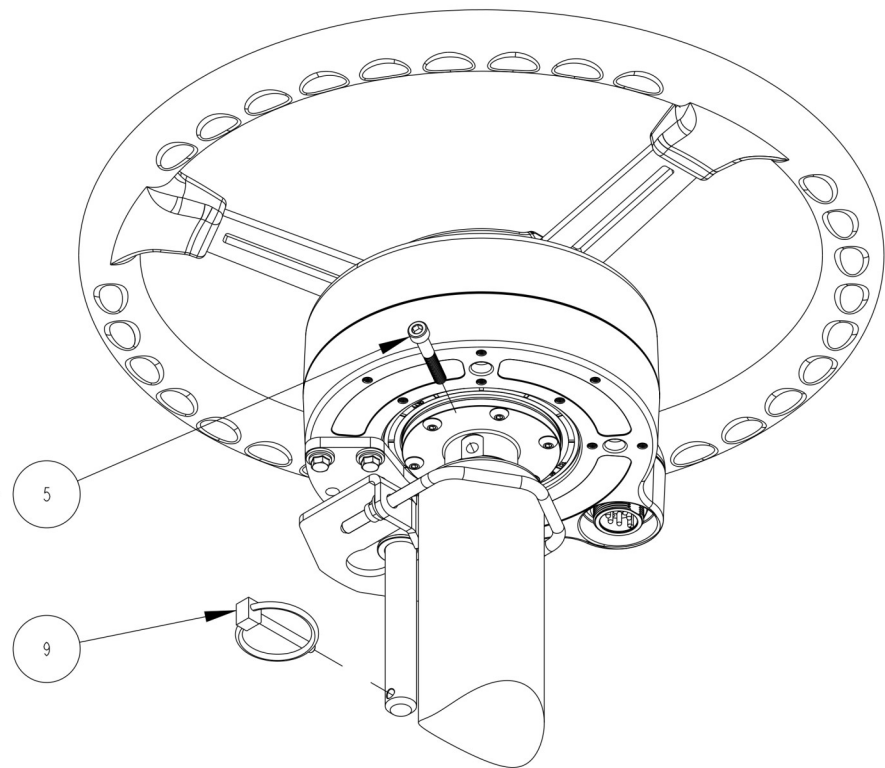

ITEM	QTY	PART NUMBER	DESCRIPTION	NOTES
1	1	604-0078-10	SPLINE ADAPTER- ESI2, M6 PIN x .750 DIA x .790 OFFSET	
2	1	640-0182-01	V-CLAMP BRACKET	
3	1	640-0183-01	T-BAR	
4	1	675-0126-000	LOCTITE 242 MEDIUM STRENGTH THREADLOCKER	NOT SHOWN
5	1	675-1306-000	SCREW, M6-1.0 X 40mm, SOCKET HEAD	
6	4	675-1348-10	SCREW, M5-0.8 X 16mm, HEX FLANGE	
7	6	675-1351-10	SCREW, M5-0.8 X 12mm, BUTTON HEAD	
8	1	675-2084-01	V-BOLT	
9	1	676-0037-000	RETAINING PIN	
10	2	676-1089-000	LOCKNUT, M6X1.0	
11	6	678-1148-10	WASHER, #12 SAE .250 ID X .562 OD	
12	1	699-0027-01	BUSHING, SPHERICAL	
13	1	910-4024-10	ESI2 ELECTRIC STEERING WHEEL	

ESi² Installation Completed

ESi² wheel successfully installed.



Install Completion Checklist

- Ensure steering wheel turns freely and anti-rotation brackets do not contact the spline adapter.
- Check, and if needed, tighten anti-rotation brackets to eliminate excess movement. Loose anti-rotation brackets can cause poor steering performance.
- For steering ECU installation instructions please refer to the ECU installation guide that came with your installation kit.